

VILLINKI®  
Lasting values



# Fresh breeze from Finnish islands

# VILLINKI®



The idea to create a new and unique furniture series has developed over the years. Our aim was to create furniture that was beautiful, durable and easy to combine.

The use of sustainable raw materials and finishing materials was considered important in manufacturing the series. The idea for a wonderful new door mechanism was also born in the peaceful surroundings of the islands of the Gulf of Finland.

**Seppo Salmevaara**

Designer





Shelf systems

# Timeless quality

The traditional craft of a cabinetmaker and contemporary technology were combined to develop the Villinki furniture series. These skills ensure the premium quality of furniture.

## Easy to combine

With the items of Villinki series you can furnish a house according to your changing needs. Easily changeable and amendable integrated sets can be created when combining the modules of the furniture series. The furniture is delivered as ready-made modules, which can be stacked on top of or next to one another.

## Naturally genuine

Villinki furniture is manufactured of durable solid birch wood. The furniture is painted (white) or stained and varnished (dark brown). All surface treatment materials are water-based.





*The doors are traditionally framed, and every window is a separate glass unit. The thickness of tempered glass is 4 mm. Furniture doors move smoothly on upper metal sliding tracks.*





*Display case elements can be easily combined into bookcases, China cabinets or display cases for exhibiting collections.*



Shelf systems

# The opportunity to furnish a unique home

Villinki display cases are available in two depths and three different heights. A new high display case gives you more possibilities to combine furniture sets and allows making better use of the height of the room.

When combining Villinki display case and cupboard modules, a TV-stand or a chest of drawers can be created as well as a large shelf system covering the whole wall. Different combinations can always be connected with one another or gradually amended.



Dining rooms and cabinets

# At the table ...





The Villinki collection includes two dining tables (height 78 cm) of different sizes: 143x90 cm and 210x90 cm. Depending on the dimensions the tables have one or two drawers opening to both sides. This beautiful detail also serves as a comfortable storage compartment.

Thanks to their extended seat, Villinki chairs provide a solid and comfortable seating.

The 144x64 cm computer desk is a comfortable and practical workplace. The desk has three drawers, whereas the middle drawer is equipped with a keyboard base. A spacious, yet a light writing desk can be complemented with a separate set of drawers on wheels.



Living room

# Beautiful and comfortable







*Sofas, armchairs and footrests can be chosen with three different foot colours.*





Bedroom

# Pleasant dreams and harmony





Made of durable birch wood, Villinki bed, nightstand, wardrobe and mirror form an enjoyable furniture set in a bedroom.

The wardrobe consists of separate elements, which is why it is suitable for rooms of different heights. A set of drawers or a wardrobe unit or both can be placed on the wardrobe's foot frame. Additional height can be added to the wardrobe with heightening elements, creating the best storage area for extra blankets and pillows. The wardrobe is finished with an upper plinth or with a simple ceiling plate.

The content of the wardrobe can be chosen according to needs — either with drawers or with a clothes rail. Stack drawer modules on top of each other and create a chest of drawers with quietly opening and closing drawers. Wardrobe doors also have a quiet closing mechanism.

The bed is available either with or without a baldachin. The decorative elements of the head and footboard of the bed repeat the unique design of Villinki display doors. The bed is suitable for a mattress of 180x200 cm.

## Hall

# A tidy hall is the visiting card of a home.

Additional storage spaces in the hall are always very welcome. In the Villinki hall shelf, clothes will always be tidily arranged on coat hooks, and caps will stay on the shelf. The comfortable seat hides a spacious storage area with hinges.

The height of the assembled shelf is 200 cm, width 90 cm and depth 40 cm.

A large drawer module together with a foot frame and a ceiling plate is a separate piece of furniture, but can be used as part of a larger combination. The chest of the wide shelf module has been divided into two.





# Examples of Villinki combinable modules



**316 High cabinet**

Dimensions: W 70 cm, H 105 cm,  
D 31 cm  
Internal dimensions: W 62 cm,  
H 100 cm, D 25 cm



**310 Small cabinet**

Dimensions: W 70 cm, H 72.5 cm,  
D 31 cm  
Internal dimensions: W 62 cm, H 68 cm,  
D 25 cm



**300 Big cabinet**

Dimensions: W 70 cm, H 81.5 cm,  
D 39 cm  
Internal dimensions: W 62 cm,  
H 77 cm, D 33 cm



**320 Big cupboard**

Dimensions: W 70 cm, H 81.5 cm,  
D 39 cm  
Internal dimensions: W 62 cm,  
H 77 cm, D 33 cm



**325 Drawer unit with 4 drawers**

Dimensions: W 70 cm, H 81.5 cm,  
D 39 cm

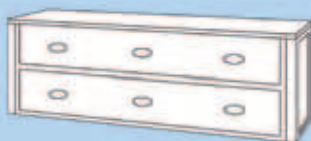

**377 Drawer unit with 2 drawers**

Dimensions: W 140 cm, H 46 cm,  
D 39 cm



**372 Drawer unit with 3 drawers**

Dimensions: W 140 cm, H 22 cm,  
D 39 cm

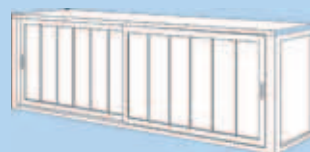

**376 Cabinet with 2 sliding doors**

Dimensions: W 140 cm, H 46 cm,  
D 39 cm  
Internal dimensions: W 67+67 cm,  
H 42 cm, D 33 cm  
Also available with smooth doors.

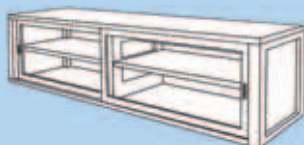

**375 TV-unit**

Dimensions: W 140 cm, H 33 cm,  
D 39 cm  
Internal dimensions: W 64.5+64.5 cm,  
H 31 cm, D 33 cm



**373 Wide open shelf**

Dimensions: W 140 cm, H 13 cm,  
D 39 cm  
Internal dimensions: W 59.5+59.5 cm,  
H 9 cm, D 37 cm



**304 Big deck unit**

Dimensions: W 70 cm, H 1.6 cm,  
D 39 cm



**374 Wide deck unit**

Dimensions: W 140 cm, H 1.6 cm,  
D 39 cm



**305 Big top unit**

Dimensions: W 70 cm, H 6.6 cm,  
D 39 cm



**302 Big base unit**

Dimensions: W 70 cm, H 5 cm,  
D 39 cm



**301 Big leg base**

Dimensions: W 70 cm, H 9 cm,  
D 39 cm



**371 Wide leg base**

Dimensions: W 140 cm, H 9 cm,  
D 39 cm

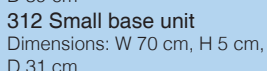

**312 Small base unit**

Dimensions: W 70 cm, H 5 cm,  
D 31 cm

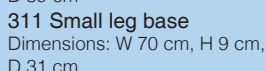

**311 Small leg base**

Dimensions: W 70 cm, H 9 cm,  
D 31 cm

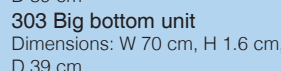

**303 Big bottom unit**

Dimensions: W 70 cm, H 1.6 cm,  
D 39 cm

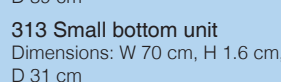

**313 Small bottom unit**

Dimensions: W 70 cm, H 1.6 cm,  
D 31 cm

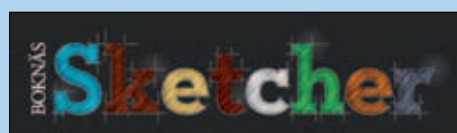

Villinki's room planning programme  
is available at [www.skano.com](http://www.skano.com).



VILLINKI®